



# SWAROVSKI

KNOBS AND HANDLES  
Innovations 2016



## Certificate of Authenticity

The seal 'crystals from Swarovski' serves as a certificate of authenticity for products with genuine Swarovski crystals.



## Advanced Crystal The New DNA of Crystal

The advantage to being first is that you get to set the agenda. Throughout its long history, Swarovski has pioneered technologies and accomplished visions that have made waves far beyond the bounds of its own industry. Now Swarovski is stepping forward to announce a dramatic change in the DNA of its crystal: the Advanced Crystal standard.

Advanced Crystal standard - a new, innovative lead-free\* crystal composition, complying with current laws and regulations governing the use of certain substances in finished products in the most relevant segments of our customer's business, and which is patented by Swarovski in the US, Japan and 16 European countries.

\* Crystal glass and all other materials containing 0.009% lead or less.

## Making Beauty Measurable: 5Cs for Quality

Beauty, as the saying goes, is in the eye of the beholder. The incomparable precision-cut crystals from Swarovski conveys beauty in all its diverse forms. Above and beyond subjective perception, the quality and value of crystal can be determined by objective criteria regardless of the material of which it is composed. Just as the value of a diamond is graded on the basis of the '4 Cs', the value of a crystal is determined by the '5 Cs'.

Swarovski is continually streamlining and developing each one of these five quality criteria and thus meets the highest standards with utmost precision, resulting in unrivalled brilliance.



### Cut.

Only cutting of the greatest precision is capable of lending crystal exceptional brilliance. Exact faceting is required to wholly achieve the prismatic effect of the crystal and bring out its full beauty. The more precisely the crystal is cut, the greater its brilliance.



### Clarity.

Crystal only has purity and clarity to the extent that it is free of inclusions such as cloudy spots, streaks, and bubbles. This requires the purest raw material and processing techniques that are carried out flawlessly.



### Color.

Perfect crystal is also characterized by color intensity and fidelity, independent of size and cut. If a crystal reflects light particularly well and disperses all its spectral colors, it will give rise to a fiery play of color in both the crystal and the immediate environment.



### Contour.

Meticulous quality control in Swarovski's manufacturing process ensures perfectly shaped, flawlessly faceted crystals.



### Care.

Sustainability concerning the selection and composition of ingredients, responsible production, and conscientious handling of legislation, customers, and the environment are essential values in modern crystal production.

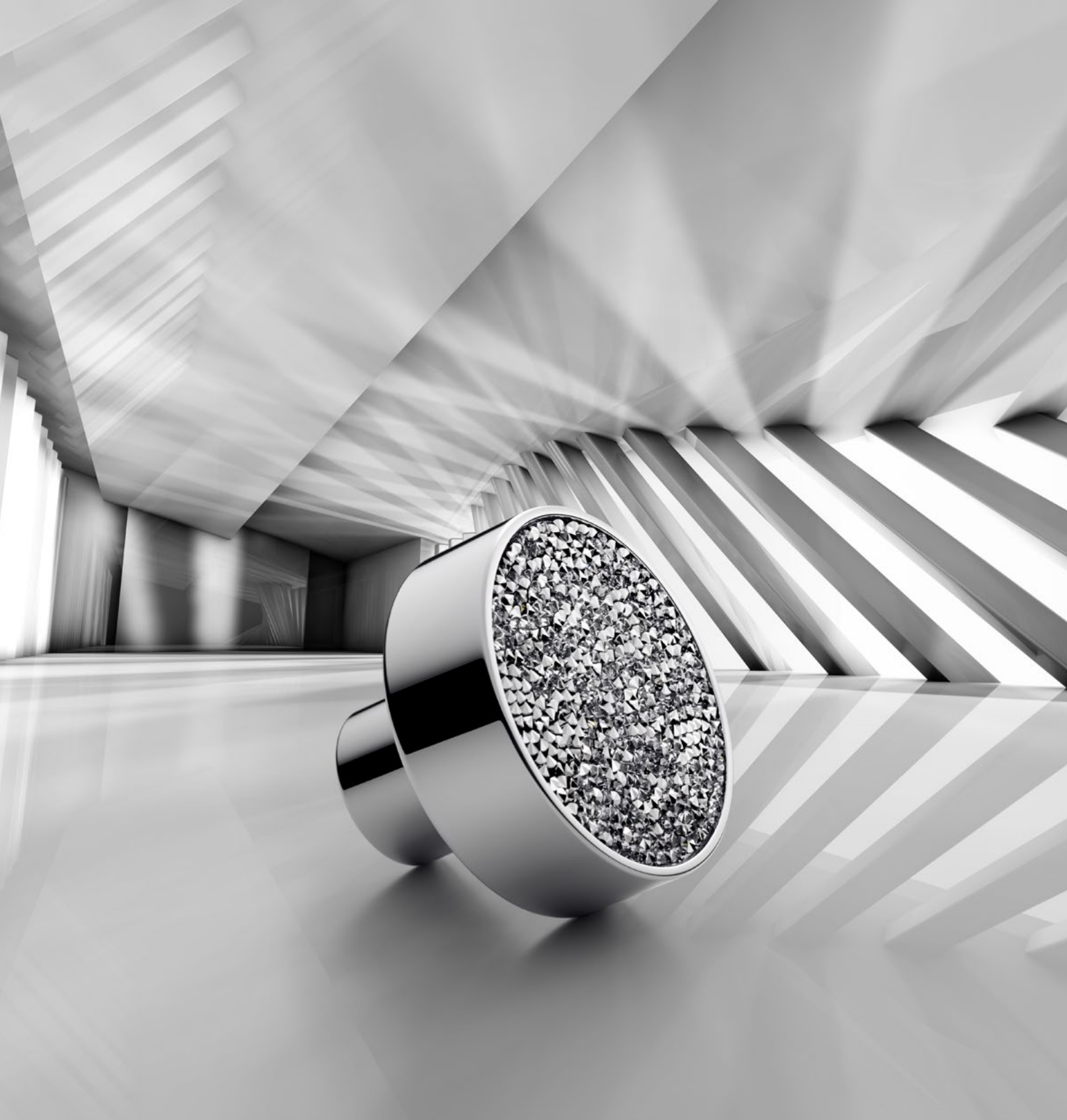

## Opening doors to sparkling ideas

The stunning collection of Knobs and Handles designed and crafted by Swarovski shines with an urbane combination of crystal and metal elements, fused together in a sophisticated, timeless, and distinctive design – a fantastic range of elegant pieces that will make every indoor space sparkle. Swarovski Knobs and Handles recommend themselves for a multitude of furniture, bath and wellness applications. All products can be easily incorporated into every spatial concept or adapted to individual customer requests. Our design experts will be at your service to make your interior design visions come true.

## EFFECT

### Crystal Silver Glaze <sup>NEW!</sup>



## MARBLE PRINTED COLOR <sup>NEW!</sup>

### Marble Bianco Carrara



### Marble Black



### Marble Blue



### Marble Rosso Verona



Field of application: Indoor (Furniture, Bath & Wellness)

Customized solution: On Demand

## 7153 Marble Printed Handle <sup>NEW!</sup>

Technical specifications for the 7153 Marble Printed Handle:

CRYSTAL PRINT	Marble Bianco Carrara	Marble Black	Marble Blue	Marble Rosso Verona
SIZE	34 mm	34 mm	34 mm	34 mm
COLOR OF CASING	081 Gold	082 Silver	082 Silver	081 Gold

## 7313 Cross Handle\* <sup>NEW!</sup>

Technical specifications for the 7313 Cross Handle:

COLOR	Crystal (001)	Crystal Silver Glaze
EFFECT	Crystal (001)	Crystal Silver Glaze
SIZE	64 mm	64 mm

**GLOBE HANDLE, CHATON HANDLE, CRYSTAL ROCKS HANDLE, XIRIUS CHATON HANDLE AND MARBLE PRINTED HANDLE**

single-sided assembly

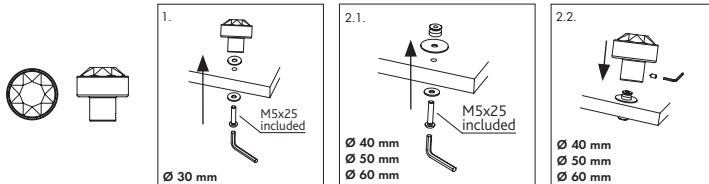

double-sided assembly

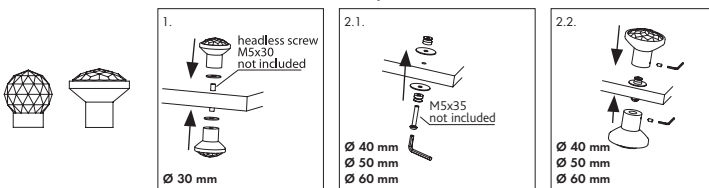

**Sequence**

1. In the first step each mounting part is attached to the desired material (e.g. wood doors etc.).
2. Afterwards, Globe Handle/Chaton Handle/Tube Handle can be applied to the previously attached mounting parts using the supplied headless screw.

**Note**

- For fragile materials, such as glass, mirrors etc., it is advisable to use the plastic washers provided.
- All enclosed mounting screws are designed for a wall thickness of a maximum of 16 mm.

**For contact information please visit: [WWW.SWAROVSKI.COM/ARCHITECTURE](http://WWW.SWAROVSKI.COM/ARCHITECTURE)  
Valid from September 2016**

Content is subject to change without notice.

Errors and misprints excepted.

D. Swarovski Distribution GmbH, Swarovskistrasse 30, 6112 Wattens, Austria

© 2016 D. Swarovski Distribution GmbH. All rights reserved. Partial or total publication, transmission, copy or other duplication of texts, graphics, pictures etc. which are to be found in this publication is forbidden without special consent by D. Swarovski Distribution GmbH.

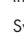
Swarovski® and  are registered trademarks by Swarovski AG.

[SWAROVSKI.COM/ARCHITECTURE](http://SWAROVSKI.COM/ARCHITECTURE)

© 2016 D. Swarovski Distribution GmbH  
Swarovski® is a registered trademark of Swarovski AG.